

HARDWARE INSTALLATION

Face Bore: 2-1/8" Edge Bore: 1"

Backset: 2-3/8" — 2-3/4" — 2"

Privacy Set—Concealed Mount Adapter Knob or Lever

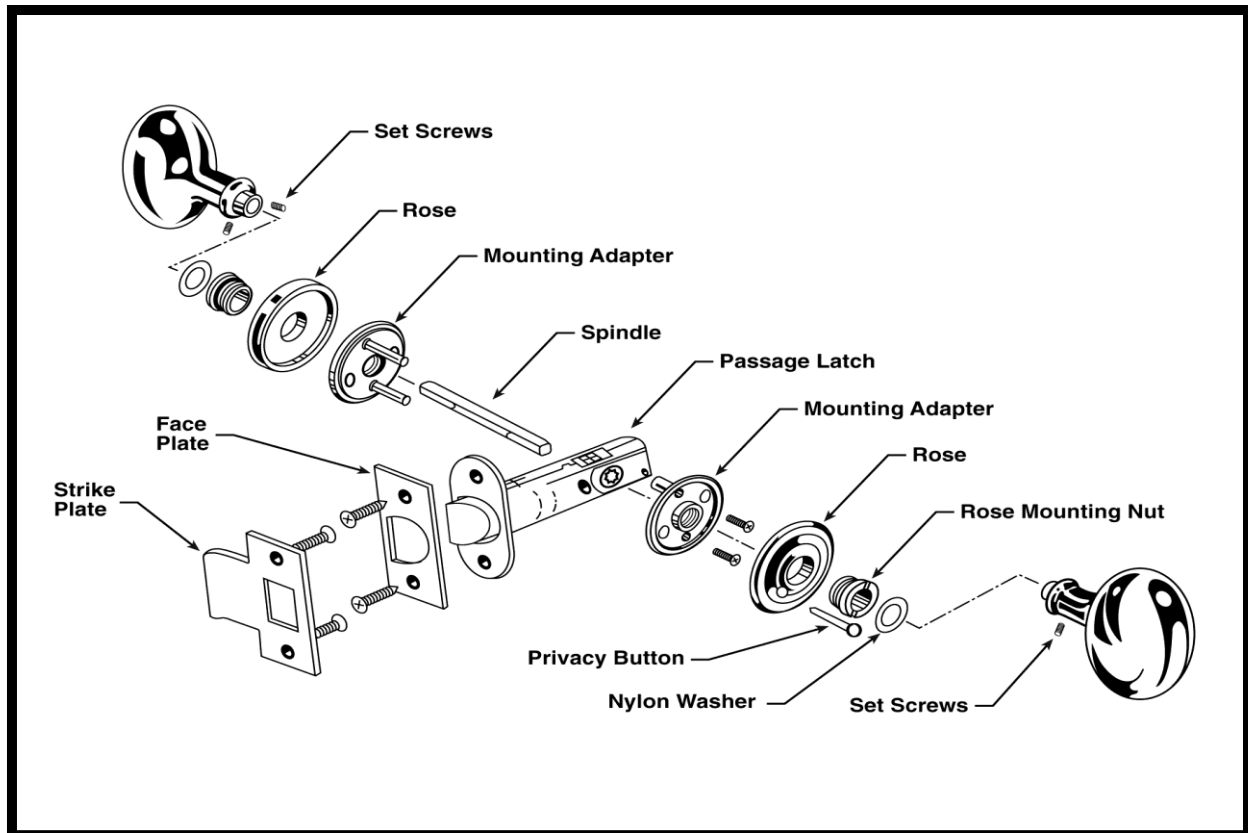

1. Mount adapter in 2-1/8" bore hole in door, with mounting screws at top and bottom
2. Insert latch in 1" edge bore on door.
3. Place rosettes over adapter hole and thread mounting nut into adapter.
4. Tighten 2-piece spindle finger tight, then back off (loosen) one full turn.
5. Insert spindle through latch hub in center of adapter, making sure to place in the "diamond" position, (edge up) with slot for set screw 45 degrees down and away from the front edge of door.
6. Adjust centering of rosette, making sure spindle is centered through rosette hole, and tighten rose mounting nut with wrench provided. Make sure privacy pin hole and safety hole are aligned with latch hole. Install privacy pin through rosette into the latch.
7. Put washer on shank of knob or lever and slide onto spindle with the set screw location lining up with set-screw slot in spindle. Make sure the spindle is nearly balanced side to side (interior/exterior). Tighten set-screws as required.
8. Mount face plate on the door and strike plate on the door jamb with screws provided.