

Discover the Best

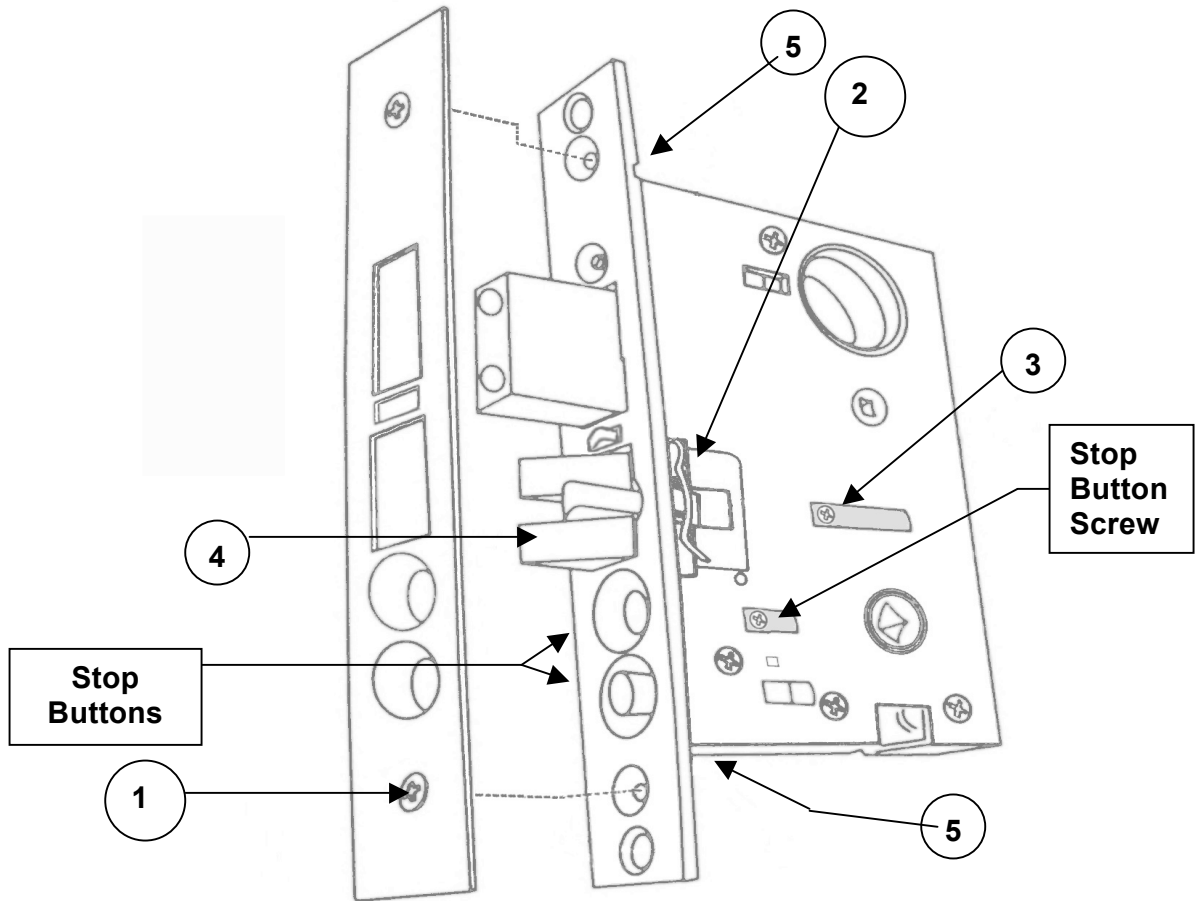

Instruction for reversing a *Brass Accents, Inc.* Mortise Lock

There are times mortise locks are ordered with the incorrect handing or may arrive at the construction site where the door handing has changed. With the **BRASS Accents, Inc.** series mortise locks, such problems are easily overcome. Below are the instructions for changing the handing on a mortise lock without opening the case:

1. Remove Part no. 1, two screws that hold the mortise face plate onto the armour front of the lock.
2. Remove Part no. 2, Cotter Pin
3. Remove Part no. 3 Screw to reverse the tongue of the mortise lock
4. Remove Part no. 5 Screws (3) and slowly remove Armour plate
5. Pull out Part no. 4 (tongue) and reverse it's direction. Replace Part no. 3 Screw to hold tongue of mortise lock in place. Alignment of Part no. 4 (tongue) is very important to allow replacement of Part no. 3 screw.
6. Replace Armour Front and re-attach with 3 screws to hold the Armour Front in place. Make sure stop-button without slot is depressed.
7. Replace Part no. 2 Cotter Pin and Part no. 3 Stop Button Screw then re-fasten Part no. 1 Face Plate Screws.
8. Depress bottom Stop Button and remove Stop Button Screw (located between the spindle hole and the Stop Buttons on the mortise body).
9. Reverse top Stop Button with a slotted screwdriver. Rotate Stop Button then replace the Stop Button Screw tightly.
10. Replace the mortise faceplate with Part no. 1 (2 screws) removed earlier. Test lock function before closing door.